

Crosby® Slip Hooks



H-331 / A-331



- Forged Carbon Steel or Forged Alloy Steel - Quenched and Tempered.
- All pins are Alloy Steel - Quenched and Tempered.
- Not Suitable for use with Grade 80 chain and chain slings used in overhead lifting. For slings or lifting chains, Grade 80 or 100 alloy components are recommended.

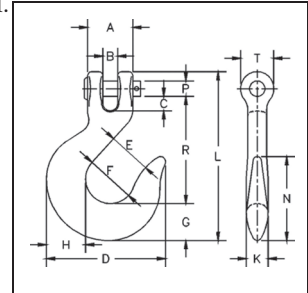

H-331 / A-331 Clevis Slip Hooks

Chain Size (mm)	Stock No.		Working Load Limit (t)*		Weight Each (kg)	Dimensions (mm)													
	H-331 Carbon	A-331 Alloy	H-331 Carbon	A-331 Alloy		A	B	C	D	E	F	G	H	K	L	N	P	R	T
7	1027383	1027524	.89	1.25	.25	26.9	8.15	7.35	70.0	23.9	30.2	20.6	22.4	12.7	100	54.0	7.87	65.5	18.3
8	1027409	1027542	1.30	1.95	.36	31.0	10.9	8.65	77.5	26.9	31.8	23.9	25.4	14.2	115	57.0	9.65	73.0	24.6
10	1027427	1027560	1.81	2.38	.55	35.1	11.4	11.2	92.0	33.3	38.1	28.7	30.2	16.8	131	65.0	11.2	82.5	26.9
11	1027445	1027588	2.27	3.18	.93	43.9	15.0	15.2	110	39.6	46.0	35.1	36.6	20.6	152	77.5	14.2	94.0	30.2
13	1027463	1027604	2.95	4.08	1.25	47.8	14.5	13.5	122	42.9	49.3	39.6	41.4	23.1	166	87.5	16.0	102	33.3
16	1027481	1027622	4.20	6.12	2.15	58.5	18.0	18.0	143	51.0	60.5	46.0	49.3	27.7	200	102	19.1	125	39.6
19	-	1027640	-	8.73	5.12	81.0	30.0	32.8	187	63.5	76.2	60.5	63.5	36.6	255	129	25.4	155	53.0

* Ultimate Load is 4 times the Working Load Limit.



H-324



- Forged Carbon Steel - Quenched and Tempered.
- Not Suitable for use with Grade 80 chain and chain slings used in overhead lifting. For slings or lifting chains, Grade 80 or 100 alloy components are recommended.

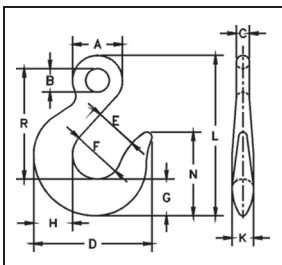

H-324 Eye Slip Hooks

Chain Size (mm)	H-324 Stock No.	Working Load Limit (t)*	Weight Each (kg)	Dimensions (mm)													
				A	B	C	D	E	F	G	H	K	L	N	R		
7	1026749	.89	.18	26.9	12.7	7.10	70.0	23.9	30.2	20.6	22.4	12.7	93.0	54.0	65.0		
8	1026767	1.30	.29	31.8	16.0	8.65	77.5	26.9	31.8	23.9	25.4	14.2	107	57.0	75.0		
10	1026785	1.81	.50	38.9	18.3	10.4	92.0	33.3	38.1	28.7	30.2	16.8	124	65.0	85.5		
11	1026801	2.27	.71	42.9	20.6	11.2	110.2	39.6	46.0	35.1	36.6	20.6	145	77.5	98.5		
13	1026829	2.95	.95	49.3	23.9	12.7	122.2	42.9	49.3	39.6	41.4	23.1	161	87.5	109		
16	1026847	4.20	1.77	60.5	28.7	16.0	143.0	51.0	60.5	46.0	49.3	27.7	195	102	133		
19	1026865	5.67	3.14	73.0	35.1	19.1	171.5	54.0	70.0	55.5	58.5	33.3	222	121	147		

* Ultimate Load is 4 times the Working Load Limit.