

# Vertical Clamps

## IP10

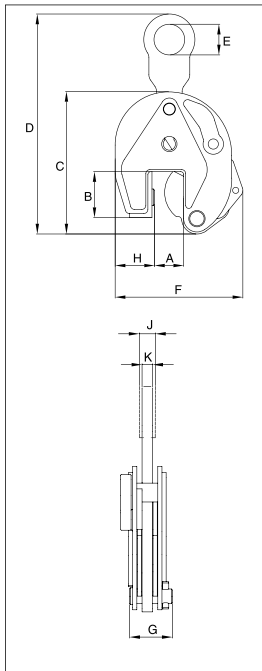

The IP10 vertical lifting clamp is used for the lifting, turning, moving or vertical transfer of sheet, plates, or fabrications from horizontal to vertical and down to horizontal (180°) as needed. Usually used as a single point pick or when used with a spreader beam with multiple vertical drop lines.



## For Vertical Lifting, Turning and Transfer

- Available in capacities of .5 thru 30 metric tons (Higher Working Load Limits are available upon request).
- Wide variety of jaw openings available: 0 to 155mm.
- Welded alloy steel body for strength and smaller size. Forged alloy components, where required.
- Individually Proof Tested to 2 times the Working Load Limit with certification.
- Company name (CrosbyIP), logo, Working Load Limit and jaw opening permanently stamped on body.
- Each product is individually serialized, with the serial number and Proof Load test date stamped on body. Serial number is included on the test certificate with maintenance and warranty logbook.
- Available in a variety of styles:
  - IP10 - Standard clamp for materials with a surface hardness to 37Rc (345 HB).
  - IP10J - Larger jaw opening.
  - IP10S - For use with Stainless Steel material.
  - IP10H - For use with materials with a surface hardness to 47Rc (450 HB).
- Full 180° turning range for material transfer, turning or moving.
- Lock open, lock closed ability with latch for pretension on material and then release of material.
- Optional IP-5000 Stinger assembly available (see page 420). Allows for easy connection between the clamp and hoist hook.
- Minimum WLL of 10% of Maximum WLL.
- Maintenance replacement kits are available.
- Manufactured by a ISO 9001 facility.
- All sizes are **RFID EQUIPPED**.



## Model IP10

Model	Working Load Limit (t)*	IP10 Stock No.	Weight Each (kg.)	Dimensions (mm)									
				Jaw A	B	C	D	E	F	G	H	J	K
IP10	0.5	2701674	1.8	0 - 16	44	128	207	30	115	41	28	-	10
IP10	1	2701662	2.2	0 - 20	45	139	215	30	126	41	38	-	10
IP10	2	2701676	7.6	0 - 35	78	201	336	70	190	61	55	-	16
IP10	3	2701664	13.8	0 - 40	100	253	436	75	225	78	60	-	20
IP10	4.5	2701666	15.0	0 - 40	100	253	436	75	232	82	65	-	20
IP10	6	2701668	23.5	0 - 50	126	302	515	80	292	84	95	40	20
IP10/J	6	2701705	28.5	50 - 100	126	302	515	80	342	84	95	40	20
IP10	9	2701670	27.5	0 - 50	126	325	550	80	310	92	105	44	25
IP10/J	9	2701672	28.5	50 - 100	126	325	555	80	360	92	105	44	25
IP10	12	2701678	49.0	0 - 54	160	391	580	80	331	117	137	41	25
IP10/J	12	2701680	58.0	54 - 108	178	439	630	80	415	117	137	41	25
IP10	16	2701682	68.0	5 - 64	178	465	690	88	397	119	153	49	25
IP10/J	16	2701684	90.0	64 - 128	208	521	746	88	472	119	161	49	25
IP10	22.5	2701686	108	5 - 80	222	554	800	110	470	136	186	49	25
IP10/J	22.5	2701688	110	80 - 155	253	628	880	110	575	136	196	49	25
IP10	30	2701690	148	5 - 80	222	545	800	110	470	152	186	54	30
IP10/J	30	2701692	152	80 - 155	250	620	880	110	565	152	196	54	30
<b>For stainless steel - with fixed hoisting eye</b>													
IP10/S	0.5	2702274	1.8	0 - 16	44	128	207	30	115	41	28	-	10
IP10/S	1	2702262	2.0	0 - 20	45	139	215	30	126	41	38	-	10
IP10/S	2	2702276	6.8	0 - 35	78	201	336	70	190	61	55	-	16
IP10/S	3	2702264	13.8	0 - 40	100	253	436	75	225	78	60	-	20
IP10/S	4.5	2702266	15.0	0 - 40	100	253	436	75	232	82	65	-	20
IP10/S	6	2702268	23.5	0 - 50	126	302	525	80	292	84	95	40	20
IP10/S	9	2702270	27.5	0 - 50	126	325	557	80	310	92	105	44	25
IP10/S	12	2702278	49.0	0 - 54	160	391	623	80	331	117	137	41	25
<b>For very hard materials - with fixed hoisting eye</b>													
IP10/H	0.5	2702174	1.8	0 - 16	44	128	207	30	115	41	28	-	10
IP10/H	1	2702176	6.8	0 - 35	78	201	336	70	190	61	55	-	10
IP10/H	2	2702164	13.8	0 - 40	100	253	436	75	225	78	60	-	16
IP10/H	3	2702166	15.0	0 - 40	100	253	436	75	232	82	65	-	20
IP10/H	4.5	2702168	23.5	0 - 50	126	302	515	80	292	84	95	40	20
IP10/H	6	2702170	27.5	0 - 50	126	325	550	80	310	92	105	44	25

\* Design Factor based on EN 13155 and ASME B30.20.

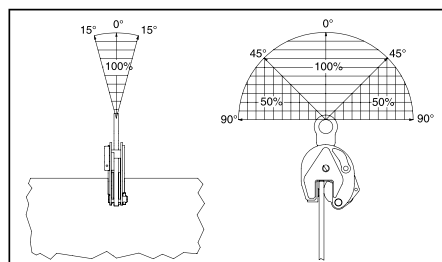

Crosby Lifting Clamps