

G-5263

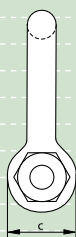
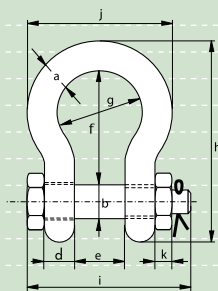

Green Pin® Super Shackles

bow shackles with safety bolt

- **Material** : bow and pin alloy steel, Grade 8, quenched and tempered
- **Safety Factor** : MBL equals 5 x WLL
- **Standard** : meets performance requirements of US Fed. Spec. RR-C-271 Type IVA Class 3, Grade B
- **Finish** : hot dipped galvanized (175 ton shackle is painted)
- **Temperature Range** : -20 °C up to +200 °C
- **Certification** : at no extra charges this product can be supplied with works certificate, 3.1 material certificate, manufacturer test certificate, EC Declaration of Conformity and all shackles starting from 150 tons are supplied with a Lloyd's Register of Shipping Certificate on proof load
- **Note** : for details on dimensions and tolerances please consult our CAD drawings, these are available on request.

working load limit	diameter bow	diameter pin	diameter eye	width eye	width inside	length inside	width bow	length bow	length bolt	width bolt	thickness nut	weight each
t	a	b	c	d	e	f	g	h	i	j	k	kg
	mm	mm	mm	mm	mm	mm	mm	mm	mm	mm	mm	
3.3	13.5	16	34	13	22	51	32	89	82	58	13	0.44
5	16	19	40	16	27	64	43	110	98	75	17	0.79
7	19	22	46	19	31	76	51	129	114	89	19	1.26
9.5	22	25	52	22	36	83	58	144	130	102	22	1.88
12.5	25	28	59	25	43	95	68	164	150	118	25	2.78
15	28	32	66	28	47	108	75	185	166	131	27	3.87
18	32	35	72	32	51	115	83	201	178	147	30	5.26
21	35	38	80	35	57	133	92	227	197	162	33	6.94
30	38	42	88	38	60	146	99	249	202	175	19	8.79
40	45	50	103	45	74	178	126	300	249	216	23	15
55	57	57	117	57	83	197	138	341	286	252	26	22
85	70	70	143	70	105	260	180	437	344	320	32	42
120	83	83	162	83	127	329	190	535	403	356	40	70
150*	95	95	208	91	147	400	238	647	511	428	50	112
175*	105	108	238	102	169	410	275	688	561	485	60	160

* = round headed bolt

In inch

working load limit	diameter bow	diameter pin	diameter eye	width eye	width inside	length inside	width bow	length bow	length bolt	width bolt	thickness nut	weight each
t	a	b	c	d	e	f	g	h	i	j	k	lbs
	inch	inch	inch	inch	inch	inch	inch	inch	inch	inch	inch	
3.3	1/2	5/8	1 11/32	1/2	7/8	2	1 1/4	3 1/2	3 7/32	2 9/32	1/2	0.97
5	5/8	3/4	1 9/16	5/8	1 1/16	2 17/32	1 11/16	4 11/32	3 27/32	2 15/16	2 1/32	1.74
7	3/4	7/8	1 13/16	3/4	1 7/32	3	2	5 3/32	4 1/2	3 1/2	3/4	2.78
9.5	7/8	1	2 1/16	7/8	1 13/32	3 9/32	2 9/32	5 21/32	5 1/8	4 1/32	7/8	4.14
12.5	1	1 1/8	2 5/16	3 1/32	1 11/16	3 3/4	2 11/16	6 15/32	5 29/32	4 21/32	3 1/32	6.13
15	1 1/8	1 1/4	2 19/32	1 3/32	1 27/32	4 1/4	2 15/16	7 9/32	6 17/32	5 5/32	1 1/16	8.53
18	1 1/4	1 3/8	2 27/32	1 1/4	2	4 17/32	3 9/32	7 29/32	7	5 25/32	1 3/16	11.6
21	1 3/8	1 1/2	3 5/32	1 3/8	2 1/4	5 1/4	3 5/8	8 15/16	7 3/4	6 3/8	1 5/16	15.3
30	1 1/2	1 5/8	3 15/32	1 1/2	2 3/8	5 3/4	3 29/32	9 13/16	7 15/16	6 7/8	3/4	19.38
40	1 3/4	2	4 1/16	1 25/32	2 29/32	7	4 31/32	11 13/16	9 13/16	8 1/2	29/32	33.07
55	2	2 1/4	4 19/32	2 1/4	3 9/32	7 3/4	5 7/16	13 7/16	11 1/4	9 29/32	1 1/32	48.50
85	2 1/2	2 3/4	5 5/8	2 3/4	4 1/8	10 1/4	7 3/32	17 7/32	13 17/32	12 19/32	1 1/4	92.59
120	3	3 1/4	6 3/8	3 9/32	5	12 15/16	7 15/32	21 1/16	15 7/8	14 1/32	1 9/16	154.32
150*	3 3/4	3 3/4	8 3/16	3 19/32	5 25/32	15 3/4	9 3/8	25 15/32	20 1/8	16 27/32	1 31/32	246.92
175*	4	4 1/4	9 3/8	4 1/32	6 21/32	16 5/32	10 13/16	27 3/32	22 3/32	19 3/32	2 3/8	352.74

* = round headed bolt

1

2

3

4

5

6

7

8

9

10

11

12

13

14

15

16