

# Crosby® Grab Hooks



## H-330 / A-330



- Forged Steel - Quenched and Tempered.
- Design factor is 4:1.
- Features quick and easy assembly.
- H-330 designed for Crosby Spectrum 4® chain.
- A-330 designed for Crosby Spectrum 7® chain.

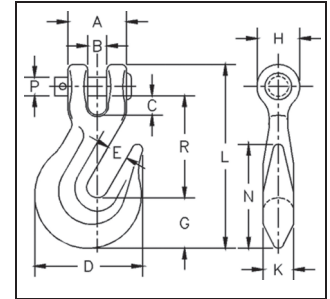

## H-330 / A-330 Clevis Grab Hooks

| Chain Size (mm) | Stock No.    |              | Working Load Limit (t) |             | Weight Each (kg) | Dimensions (mm) |      |      |      |      |      |      |      |      |      |      |      |
|-----------------|--------------|--------------|------------------------|-------------|------------------|-----------------|------|------|------|------|------|------|------|------|------|------|------|
|                 | H-330 Carbon | A-330 Alloy* | H-330 Carbon           | A-330 Alloy |                  | A               | B    | C    | D    | E    | G    | H    | K    | L    | N    | P    | R    |
| 7               | 1027105      | 1027249*     | 1.18                   | 1.59        | .16              | 25.4            | 8.15 | 7.85 | 46.0 | 8.65 | 22.4 | 18.3 | 11.9 | 77.5 | 44.5 | 7.85 | 41.7 |
| 8               | 1027123      | 1027267*     | 1.77                   | 2.04        | .29              | 30.2            | 9.90 | 9.15 | 54.0 | 11.2 | 24.6 | 23.1 | 15.0 | 93.0 | 52.5 | 9.65 | 61.5 |
| 10              | 1027141      | 1027285*     | 2.45                   | 3.22        | .45              | 35.1            | 11.4 | 11.4 | 64.5 | 12.7 | 29.7 | 25.4 | 18.3 | 109  | 59.5 | 11.2 | 61.0 |
| 11              | 1027169      | 1027301      | 3.27                   | 4.54        | .59              | 42.2            | 16.8 | 15.7 | 78.5 | 14.2 | 33.3 | 28.7 | 17.5 | 125  | 67.5 | 14.2 | 70.0 |
| 13              | 1027187      | 1027329*     | 4.17                   | 5.44        | .95              | 47.8            | 14.5 | 17.8 | 90.5 | 16.8 | 38.9 | 31.8 | 19.8 | 145  | 75.5 | 16.0 | 81.0 |
| 16              | 1027203      | 1027347      | 5.90                   | 8.2         | 1.91             | 58.0            | 23.1 | 21.3 | 112  | 19.8 | 45.2 | 39.6 | 27.7 | 179  | 109  | 19.1 | 104  |
| 19              | 1027221      | 1027365      | 9.16                   | 11.2        | 2.95             | 66.5            | 23.9 | 23.9 | 133  | 23.9 | 54.0 | 47.8 | 33.3 | 207  | 129  | 22.4 | 118  |

\* These A-330 hooks are forged with an "8" designating Grade 80, and are suitable for use with Grade 8 chain in over head lifting applications as long as hook is Proof Tested as part of the chain sling assembly or as an individual component per ASME B30.9. We recommend the use of the A-338 which is proof-tested and supplied with a proof test certificate.

## H-323 / A-323



- Forged Steel - Quenched and Tempered.
- Design Factor is 4:1.
- H-323 designed for Crosby Spectrum 4® chain.
- A-323 designed for Crosby Spectrum 7® chain.

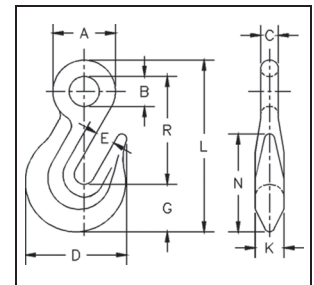

## H-323 / A-323 Eye Grab Hooks

| Chain Size (mm) | Stock No.    |              | Working Load Limit (t) |       | Weight Each (kg) | Dimensions (mm) |      |      |      |      |      |      |      |      |      |  |
|-----------------|--------------|--------------|------------------------|-------|------------------|-----------------|------|------|------|------|------|------|------|------|------|--|
|                 | H-323 Carbon | A-323 Alloy* | H-323                  | A-323 |                  | A               | B    | C    | D    | E    | G    | K    | L    | N    | R    |  |
| 7               | 1026204      | 1026384*     | 1.18                   | 1.59  | .13              | 27.7            | 13.5 | 7.85 | 46.0 | 8.65 | 22.4 | 11.9 | 77.5 | 44.5 | 47.8 |  |
| 8               | 1026222      | 1026400*     | 1.77                   | 2.04  | .20              | 33.3            | 15.7 | 9.65 | 54.0 | 11.2 | 24.6 | 15.0 | 91.0 | 52.5 | 58.0 |  |
| 10              | 1026240      | 1026428*     | 2.45                   | 3.22  | .36              | 39.6            | 19.1 | 11.2 | 64.5 | 12.7 | 29.7 | 18.3 | 109  | 59.5 | 68.5 |  |
| 13              | 1026286      | 1026464*     | 4.17                   | 5.44  | .79              | 49.3            | 22.4 | 13.5 | 90.5 | 16.8 | 38.9 | 19.8 | 138  | 75.5 | 86.0 |  |
| 16              | 1026302      | 1026482*     | 5.90                   | 8.21  | 1.47             | 60.5            | 26.9 | 16.8 | 112  | 19.8 | 48.0 | 25.4 | 169  | 96.0 | 104  |  |
| 19              | 1026320      | 1026507      | 9.16                   | 11.2  | 2.69             | 73.0            | 35.1 | 19.1 | 133  | 23.9 | 54.0 | 33.3 | 205  | 129  | 131  |  |

\* These A-323 hooks are forged with an "8" designating Grade 80, and are suitable for use with Grade 8 chain in over head lifting applications as long as hook is Proof Tested as part of the chain sling assembly or as an individual component per ASME B30.9. We recommend the use of the A-328 which is proof tested and supplied with a proof test certificate.

## BL-GRB



### Bullard Alloy Grab Hook with Latch

- Dimensions shown relate to H-323 / A-323 drawing scheme shown above.

| Chain Size (mm) | BL-GRB Stock No. | Working Load Limit (t)* | Weight Each (kg) | Dimensions (mm) |      |      |      |      |      |      |      |      |      |  |
|-----------------|------------------|-------------------------|------------------|-----------------|------|------|------|------|------|------|------|------|------|--|
|                 |                  |                         |                  | A               | B    | C    | D    | E    | G    | K    | L    | N    | R    |  |
| 7               | 1051904          | 1.60                    | .23              | 31.8            | 14.2 | 7.11 | 62.7 | 10.2 | 21.8 | 13.5 | 93.5 | 55.4 | 63.5 |  |

\* Ultimate Load is 4 times the Working Load Limit.