

Grade 80 Alloy Fittings



A-328



- Alloy Steel - Quenched and Tempered.
- Individually Proof Tested at 2-1/2 times the Working Load Limit with certification.
- The use of A-328 Eye Grab Hook will result in a 20 percent reduction in chain capacity. When used to hook back to chain leg to form a choker, the angle of the choke must be 120 degrees or greater. When used as a chain shortener, minimize twist of chain and ensure chain is fully engaged in hook.

A-328 Eye Grab Hook

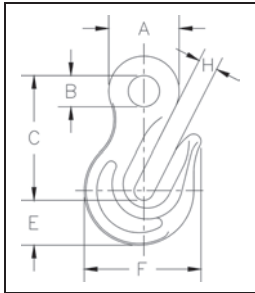

Chain Size (mm)	A-328 Stock No.	Working Load Limit (t)*	Weight Each (kg)	Dimensions (mm)					
				A	B	C	E	F	H
7	1026017	1.59	.27	35.1	15.0	65.0	23.1	55.0	9.65
10	1026035	3.22	.54	45.7	20.3	82.5	29.5	76.0	12.7
13	1026053	5.45	1.36	57.0	24.9	106	42.9	102	16.0
19	1026099	12.84	3.74	82.0	34.5	151	55.5	139	22.4
22	1026115	15.51	5.40	94.0	39.4	175	65.0	160	26.9

* Ultimate Load is 4 times the Working Load Limit.



A-338



- Alloy Steel - Quenched and Tempered.
- Individually Proof Tested at 2-1/2 times the Working Load Limit with certification.
- Pin locking requires no special tools.
- The use of A-338 Clevis Grab Hook will result in a 20 percent reduction in chain capacity. When used to hook back to chain leg to form a choker, the angle of the choke must be 120 degrees or greater. When used as a chain shortener, minimize twist of chain and ensure chain is fully engaged in hook.

A-338 Clevis Grab Hook

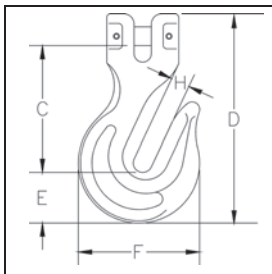

Chain Size (mm)	A-338 Stock No.	Working Load Limit (t)*	Weight Each (kg)	Dimensions (mm)				
				C	D	E	F	H
7	1027659	1.59	.28	66.5	106	22.6	55.0	9.65
10	1027677	3.22	.57	81.5	132	29.5	76.0	12.7
13	1027686	5.45	1.56	106	177	42.9	102	15.7
16	1027695	8.21	2.56	128	210	47.8	118	19.1
19	1027702	12.84	4.72	151	253	55.5	134	22.4
22	1027711	15.51	6.18	176	294	65.0	155	25.4

* Ultimate Load is 4 times the Working Load Limit.