

Grade 100 Alloy Master Links



Crosby 8/10™

A-1342N



- Alloy Steel - Quenched and Tempered.
- Individually proof tested to 2.5 times the Working Load Limit with certification.
- Proof tested with fixture sized to prevent localized point loading per ASTM A952.
- Proof test certification shipped with each link.
- All sizes are drop forged.
- "Look for the Platinum Color - Crosby Grade 100 Alloy Products."
- Engineered Flat for use with S-1325A coupler link.

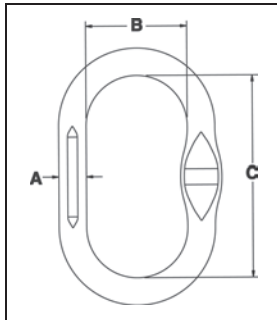

A-1342N Master Link

A-1342N Size		A-1342N Designation Marking	A-1342N Stock No.	Working Load Limit (t)*	Proof Load (t)	Weight Each (kg)	Dimensions (mm)		
(in.)	(mm)						A	B	C
1/4	6 - 7	X 1	1011403	3.12	7.8	.49	15.2	63.5	127
5/16	8	X 2	1011412	4.16	10.4	.77	17.8	69.9	140
3/8	10	X 3	1011421	6.40	16.0	1.22	21.3	76.2	152
1/2	13	X 4	1011430	10.92	27.3	2.81	27.7	102	203
5/8	16	X 5	1011449	16.40	41.0	4.80	34.0	127	229
3/4	19	X 6	1011458	25.7	64.2	8.52	41.4	133	267
7/8	22	X 7	1011467	31.0	77.6	13.1	47.8	152	305

* Minimum Ultimate Load is 4 times the Working Load Limit based on single leg sling.



Crosby 8/10™

A-1345N



- Alloy Steel - Quenched and Tempered.
- Individually proof tested to 2.5 times the Working Load Limit with certification.
- Proof tested with fixture sized to prevent localized point loading per ASTM A952.
- Proof test certification shipped with each link.
- "Look for the Platinum Color - Crosby Grade 100 Alloy Products."
- Engineered Flat for use with S-1325A coupler link.

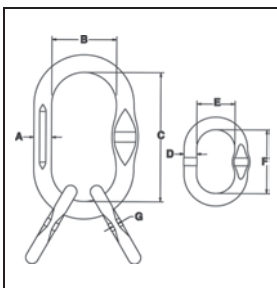

A-1345N Master Link Assembly

A-1345N Designation Marking	A-1345N Stock No.	Grade 100 Chain Size		Working Load Limit (t)*	Proof Load (t)	Weight Each (kg)	Dimensions (mm)						
		(in.)	(mm)				A	B	C	D	E	F	G
X 2	1011501	-	6	3.48	8.7	1.31	17.8	69.9	140	12.7	38.6	85.1	6.10
X 3	1011510	1/4 - 5/16	7 - 8	6.20	15.5	1.99	21.3	76.2	152	14.3	45.0	85.1	7.62
X 4	1011529	3/8	10	9.58	24.0	4.35	27.7	102	203	19.1	59.9	100	8.38
X 5	1011538	1/2	13	16.33	40.9	8.75	34.0	127	229	25.4	89.9	160	12.9
X 6	1011547	5/8	16	24.60	61.5	14.2	38.1	133	267	31.8	100	180	16.5
X 7	1011556	3/4	19	38.44	96.1	24.6	47.8	152	305	38.1	108	203	20.6
X 8	1011565	7/8	22	46.50	116.2	50.9	57.2	203	406	47.8	152	305	22.4

* Minimum Ultimate Load is 4 times the Working Load Limit based on single leg sling.